



TAPEDIMMER-RF1

Instruction manual - H11706 - V1 - 05/2024

1 - Introduction

The TAPEDIMMER-RF1 supports manual dimming by button and dimming by 2.4GHz remote control (REMOTECTL4x2 or PILOTCTL-4x2). By default, it can be controlled by any remote control and in any zone. It is possible to assign the TAPEDIMMER-RF1 to a zone on the remote control. In this case the RF codes must be matched before installation.

2 - Description and characteristics

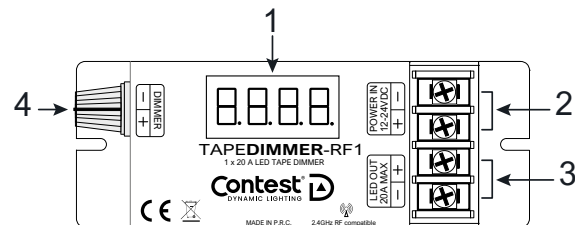

- 1 - Display: indicates the status of the various functions in progress
- 2 - Power supply input 12-24V DC
- 3 - LED output
- 4 - Dimmer / push button

| | |
|-----------------------|---|
| Operating voltage | DC 12-24V |
| Output | 1 channel |
| Memory storage | Yes |
| PWM frequency | 2KHz (default), 500Hz, 1KHz, 4KHz, 7.8KHz and 15.6KHz |
| Maximum output power | PWM ≤ 2 KHz : 20A ; 480W/24V PWM = 4/7.8 KHz : 15A ; 360W/24V PWM = 15.6 KHz : 10A ; 240W/24V |
| Protection | Against short circuits |
| Operating temperature | -20-60°C |
| Static consumption | < 1 W |
| Dimensions | 103 x 40 x 24 mm |
| Weight | 65 g |

3 - Wiring principle

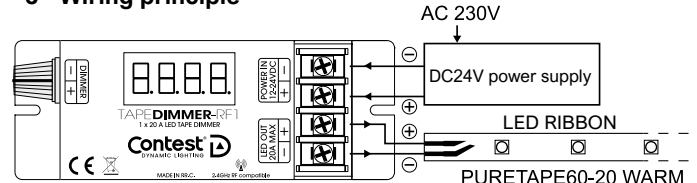

Wiring must be carried out with the power off. The operating voltage ranges from 12 to 24V. Make sure that no other voltage is used. Check that there are no short circuits before commissioning.

4 - Adjustment and use

- 1 - The drive is operated as follows:
 - Rotation allows the output level to be varied proportionally from 0 to 100%.
 - By clicking on the dimmer, you can vary the output level in stages: 10%, 30%, 50%, 70%, 100%.
- 2 - The PWM dimming frequency is adjustable via the dimmer. The maximum output power corresponding to the different PWM frequencies is different. Please do not overload it.
- 3 - PWM display: P005=500Hz / P010=1KHz / P020=2KHz (factory default) / P040=4KHz / P078=7.8KHz / P156=15.6KHz.

Setting the PWM frequency :

Press and hold the button for 5 seconds to activate the PWM setting. The display will show Pxxx, indicating that PWM control has been activated. Turn the knob to set the PWM frequency and press the knob briefly to save the setting.

Note: the PWM setting operation must be completed within one minute. After 60 seconds, the device automatically exits the PWM setting state without saving it.

5 - Wireless link and synchronisation

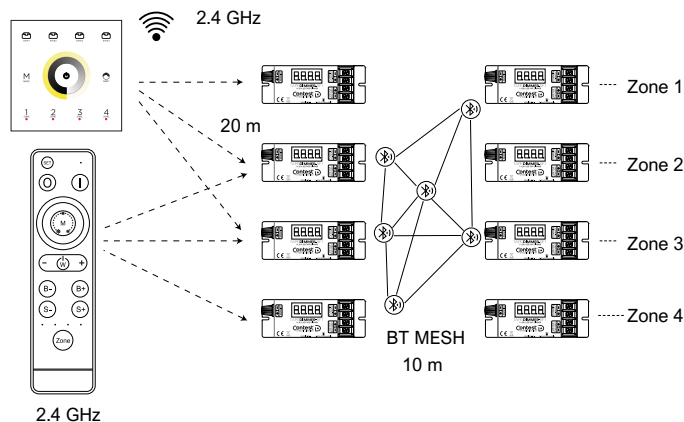

6 - RF pairing of remote controls

6-1 - Pairing: Transmitting the code to the receiver

| Stage | Action | Instruction |
|-------|---|--|
| 1 | Switch on the receiver. | 1 - It is first necessary to delete the code if the receiver has previously been coded. See paragraph 6.2 below. 2 - Several code pairings can be carried out within the range of the remote control or controller. |
| 2 | Select the zone | Use the Zone button and the corresponding indicator will light up. |
| 3 | Press and hold the "ON" button on the remote control or the "SAVE 1" button on the wall controller for 5 seconds. The indicator LED flashes rapidly, indicating that the pairing code is being transmitted. | The remote control or wall controller automatically exits transmission mode after 60 seconds or after any key is pressed. |
| 4 | The indicator LED flashes 3 times and returns to the initial state. | The pairing procedure is complete. |

6-2 - Disassociation: Deletion of the receiver code

| Stage | Action | Instruction |
|-------|--|--|
| 1 | Switch on the receiver. | 1 - The erasing operation must be completed within one minute of the receiver being powered up. If this time limit is exceeded, the receiver can be powered up again to restart the operation. 2 - Several code deletions can be made within the range of the remote control. |
| 2 | Press and hold the "OFF" button on the remote control or the "SAVE 2" button on the wall controller for 5 seconds. The indicator LED flashes rapidly, indicating that code erase mode is in progress. It is not necessary to select the corresponding zone when deleting the code. | 1 - The remote control or wall controller automatically exits transmission mode after 60 seconds or after any key is pressed. 2 - If the original remote control is lost, a new remote control can be used for erasing operations. |
| 3 | The indicator LED flashes 3 times and returns to the initial state. | The code deletion procedure is complete. |

6-3 - Copying a code from a receiver

| Stage | Action | Instruction |
|-------|--|---|
| 1 | Switch off the receiver. | The one that will be controlled by the remote control or the wall controller. |
| 2 | Press and hold the "Mode" button on the remote control or the "ON/OFF" button on the controller. If you press and hold the wall key for 5 seconds, the L E D will go from 100% to off, indicating that the code is being received. | The remote control or wall controller automatically exits reception mode after 30 seconds or when the code is received. |
| 3 | Switch on the receiver. The remote control indicator LED flashes 3 times. | The code copy is complete. |

- For the safety of the system, the distance between the remote control and the receiver must be less than 2 metres.
- Only one operation is required for the whole system, there is no need to perform different operations for different zones, all the parameters will be repeated.

6-4 - Correspondence between remote control and panel keys in parameter-setting mode

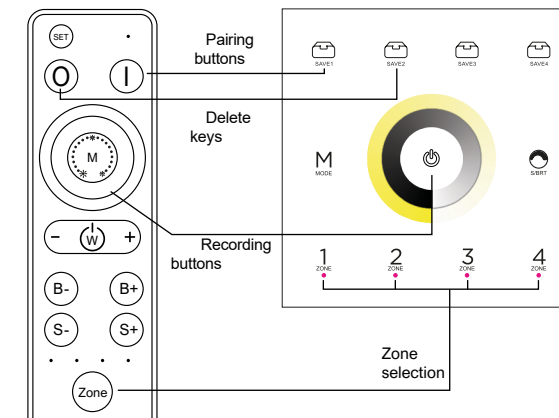

The CONTEST® brand takes the greatest care in the manufacture of its products to guarantee you the best quality. Changes may therefore be made without prior notice. For this reason, the technical characteristics and physical configuration of the products may differ from the specifications and illustrations presented in this manual. For the latest product information and updates visit <https://dyna.lighting/> CONTEST® is a trademark of HITMUSIC S.A.S - 595 rue de la Pièce Grande - 46230 FONTANES - FRANCE www.hitmusic.eu